

100% Money Back
Guarantee

Vendor:Microsoft

Exam Code:AZ-200

Exam Name:Microsoft Azure Developer Core
Solutions (beta)

Version:Demo

QUESTION 1

HOT SPOT

You need to ensure that security requirements are met.

What value should be used for the `ConnectionString` field on line DB03 in the Database class? To answer, select the appropriate answer area;

NOTE: Each correct selection is worth one point.

Hot Area:

"Data Source=datastore.database.windows.net; Initial Catalog=experise;

Integrated Security=SSPI
Trusted_Connection=False
Network Library=DBMSSOCN
MultipleActiveResultSets=True

Encrypt=True
Integrated Security=True
Follower Partner=False
Named Poise=True

Correct Answer:

"Data Source=datastore.database.windows.net; Initial Catalog=experise;

Integrated Security=SSPI
Trusted_Connection=False
Network Library=DBMSSOCN
MultipleActiveResultSets=True

Encrypt=True
Integrated Security=True
Follower Partner=False
Named Poise=True

QUESTION 2

DRAG DROP

You have a web app named MainApp. You are developing a triggered App Service background task by using the WebJobs SDK. This task automatically invokes a function in the code whenever any new data is received in a queue.

You need to configure the services.

Which service should you use for each scenario? To answer, drag the appropriate services to the correct scenarios. Each service may be used once, more than once, or not at all. You may need to drag the split bar between panes or scroll to

view content.

NOTE: Each correct selection is worth one point.

Select and Place:



Correct Answer:



QUESTION 3

Note: This question is part of a series of questions that present the same scenario. Each question in the series contains a unique solution. Determine whether the solution meets the stated goals.

You need to ensure that the SecurityPin security requirements are met.

Solution: Enable Always Encrypted for the SecurityPin column using a certificate contained in Azure Key Vault and grant the WebAppIdentity service principal access to the certificate.

Does the solution meet the goal?

- A. Yes
- B. No

Correct Answer: A

QUESTION 4

DRAG DROP

You need to deploy a new version of the LabelMaker application.

Which three actions should you perform in sequence?

To answer, move the appropriate actions from the list of actions to the answer area and arrange them in the correct order.

Select and Place:

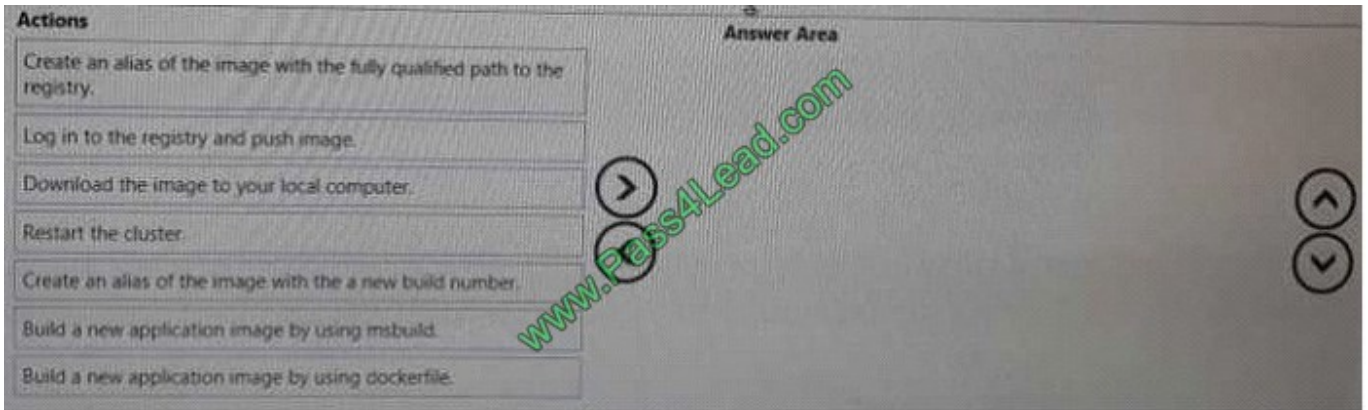

Correct Answer:

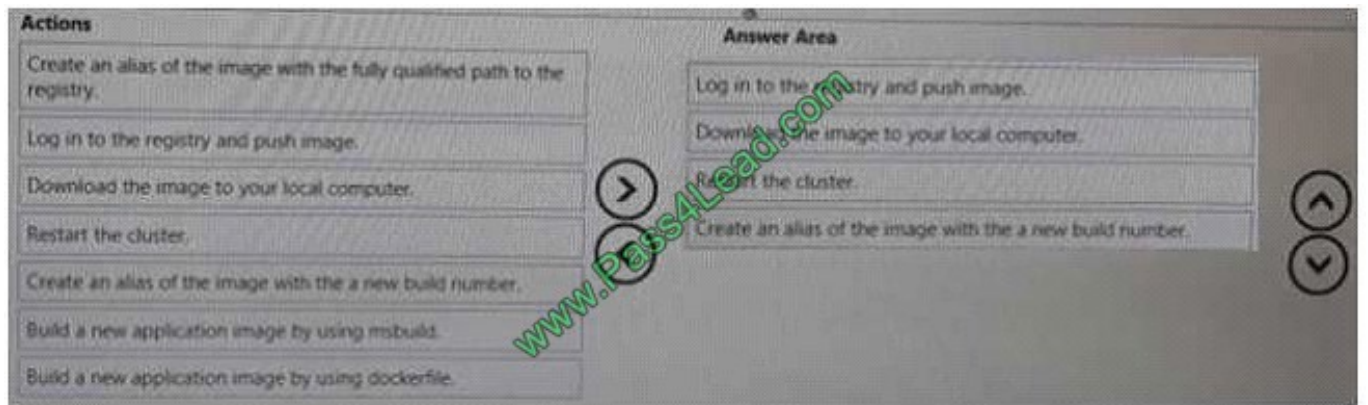
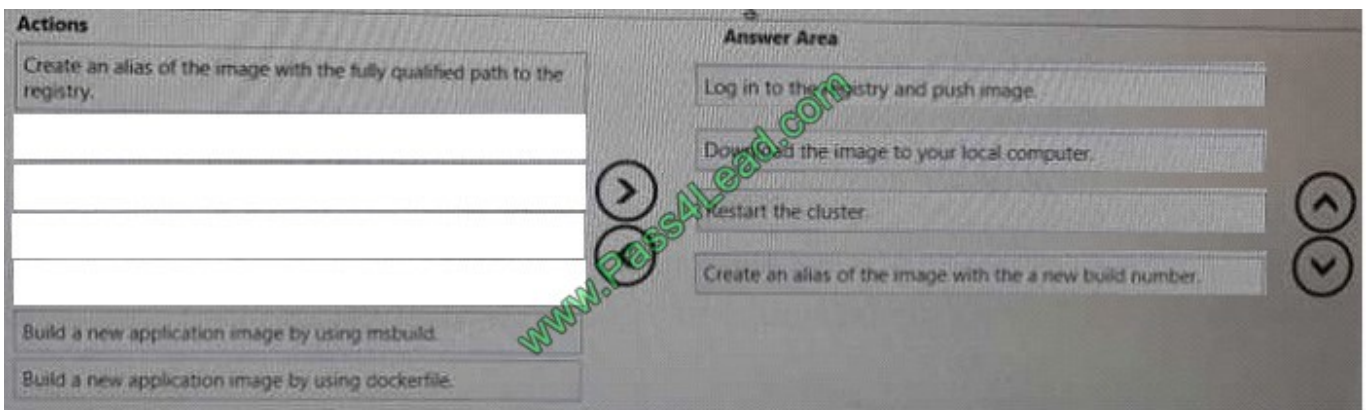

QUESTION 5

You develop software solutions for a media services company. You plan to analyze a collection of video files by using Azure Video Indexer.

You need to only generate audio transcripts from the files, as quickly as possible, without incurring extra costs.

To which value should you set the Azure Video Indexer streammgPreset option?

- A. Default
- B. SingleBitrate
- C. NoStreaming
- D. AdaptiveBitrate

Correct Answer: C

QUESTION 6

HOT SPOT

You need to ensure that you can deploy the LabelMak.e application

How should you complete the CU commands? To answer, select the appropriate options in the answer area;

NOTE: Each correct selection is worth one point.

Hot Area:

Answer Area

Correct Answer:

Answer Area

Answer Area

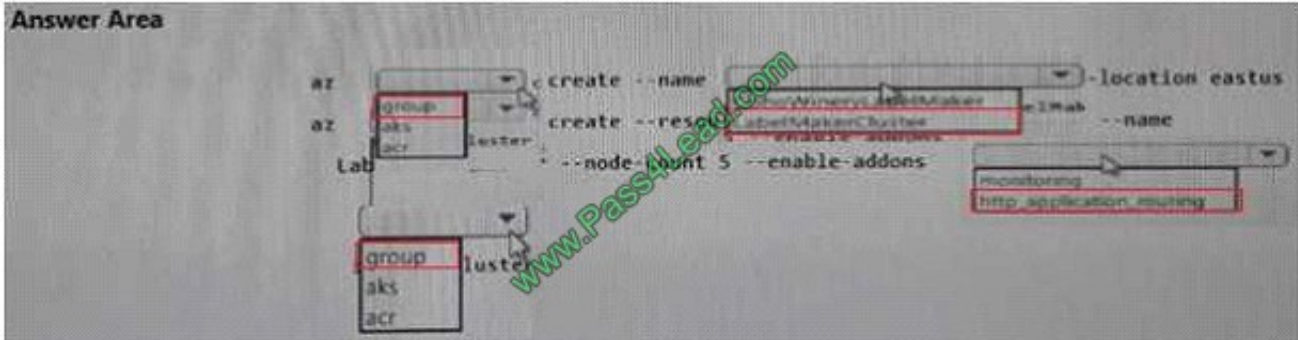

QUESTION 7

You are expanding an existing on-premises application to connect to several applications in the cloud. You have the following requirements:

Automate various business processes and send data to multiple SaaS and Use workflows and a publish-subscribe model

Prohibit changes to the on-premises application

You need to create a solution.

What should you use?

- A. Azure Service Bus
- B. Azure Web Apps
- C. Logic Apps with Azure Event Grid
- D. Azure Service Fabric

Correct Answer: C

QUESTION 8

You manage a web application that is hosted in multiple Azure regions. The application uses Azure Append blobs to store audit logs. Each hosted instance of the application maintains its own audit logs.

You have a central Append blob that serves as a master record of all audit logs. The master audit log is updated on a schedule to include all local copies from each region. The local copies are then discarded.

You need to append each of the local audit logs to the master audit log.

Which method should you use?

- A. Start-AzureStorageBlobCopy PowerShell command
- B. Append Block operation of the Azure Storage Services REST API

C. Copy Blob operation of the Azure Storage Services REST API

D. AzCopy tool with the /BlobType:Append parameter

Correct Answer: B

QUESTION 9

HOT SPOT

You need to add the Supporting Operating Systems section to the Getting Started document.

How should you complete the section? To answer, select the appropriate options in the answer area;

NOTE: Each correct selection is worth one point.

Hot Area:

Operating System	Supported
Windows 7	<input data-bbox="857 972 1481 1043" type="text"/> <input data-bbox="857 1043 1099 1115" type="checkbox"/> Yes <input data-bbox="857 1115 1099 1182" type="checkbox"/> No
Windows 8.1	<input data-bbox="857 1267 1481 1339" type="text"/> <input data-bbox="857 1339 1099 1411" type="checkbox"/> Yes <input data-bbox="857 1411 1099 1478" type="checkbox"/> No
Windows 10	<input data-bbox="857 1559 1481 1630" type="text"/> <input data-bbox="857 1630 1099 1702" type="checkbox"/> Yes <input data-bbox="857 1702 1099 1769" type="checkbox"/> No

Correct Answer:

Operating System

Supported

Windows 7

 Yes
 No

Windows 8.1

 Yes
 No

Windows 10

 Yes
 No

QUESTION 10

You connect to Azure by using a workstation that has a slow internet connection. You have two Azure file shares. You plan to transfer a series of large files from one container to another container. The workstation does not have sufficient disk space to store the files.

You define the following variables in Azure PowerShell:

Variable	Description
<code>\$sourceServer</code>	This variable represents the container that stores the files.
<code>\$destServer</code>	This variable represents the container where files will be copied.
<code>\$sourceKey</code>	This variable represents the primary key of the source storage account.
<code>\$destKey</code>	This variable represents the primary key of the destination storage account.

You need to simultaneously transfer the large files as efficiently as possible.

Solution: Run the following Azure PowerShell command:

```
AzCopy /Source:$sourceServer /Dest:$Dest5server /SourceKey:JsourcKey /DestKey:$destkey / S
```

Does the solution meet the goal?

A. Yes

B. No

Correct Answer: B

QUESTION 11

You are developing an ASP.NET web application that you will deploy to Azure.

The solution must meet the following requirements:

Store user session state by using only serializable data types.

Provide customizable caching of session data;

Support scaling out the number of web hosts.

?Maximize performance.

Which solution meets these requirements?

A. Clustered Azure Redis Cache

B. SQL Server session state provider

C. in memory session state provider

D. ASP .NET Output Cache provider for Azure Redis Cache

Correct Answer: B

QUESTION 12

HOT SPOT

You store customer information in Azure Cosmos DB. The following data already exists in the database:

PartitionKey	RowKey	Email
Harp	Walter	wharp@contoso.com
Smith	Steve	ssmith@contoso.com
Smith	Jeff	jsmith@contoso.com

You develop the following code. (Line numbers are included for reference only.)

```

1 CloudTableClient tableClient = account.CreateCloudTableClient();
2 CloudTable table = tableClient.GetTableReference("people");
3 TableQuery<CustomerEntity> query = new TableQuery<CustomerEntity>()
4     .Where(TableQuery.CombineFilters(
5         TableQuery.GenerateFilterCondition(PartitionKey, QueryComparisons.Equal, "Smith"),
6         TableOperators.And, TableQuery.
7             GenerateFilterCondition(Email, QueryComparisons.Equal, "ssmith@contoso.com")
8     ));
8 await table.ExecuteQuerySegmentedAsync<CustomerEntity>(query, null);

```

For each of the following statements, select Yes if the statement is true. Otherwise, select No. NOTE: Each correct selection is worth one point.

Hot Area:

Answer Area

The code returns every Record where the surname equals Smith .	Yes <input type="radio"/>	No <input type="radio"/>
The table endpoint <code>.../mytableendpoint/People (PartitionKey='Smith', RowKey='Steve')</code> returns the same results as the code.	<input type="radio"/>	<input type="radio"/>

Correct Answer:

Answer Area

The code returns every Record where the surname equals Smith .	Yes <input checked="" type="radio"/>	No <input type="radio"/>
The table endpoint <code>.../mytableendpoint/People (PartitionKey='Smith', RowKey='Steve')</code> returns the same results as the code.	<input type="radio"/>	<input checked="" type="radio"/>

Answer Area

The code returns every Record where the surname equals Smith .	Yes <input checked="" type="radio"/>	No <input type="radio"/>
The table endpoint <code>.../mytableendpoint/People (PartitionKey='Smith', RowKey='Steve')</code> returns the same results as the code.	<input type="radio"/>	<input checked="" type="radio"/>

To Read the [Whole Q&As](#), please purchase the [Complete Version](#) from [Our website](#).

Try our product !

100% Guaranteed Success

100% Money Back Guarantee

365 Days Free Update

Instant Download After Purchase

24x7 Customer Support

Average **99.9%** Success Rate

More than **800,000** Satisfied Customers Worldwide

Multi-Platform capabilities - **Windows, Mac, Android, iPhone, iPod, iPad, Kindle**

Need Help

Please provide as much detail as possible so we can best assist you.

To update a previously submitted ticket:



 <p>One Year Free Update Free update is available within One Year after your purchase. After One Year, you will get 50% discounts for updating. And we are proud to boast a 24/7 efficient Customer Support system via Email.</p>	 <p>Money Back Guarantee To ensure that you are spending on quality products, we provide 100% money back guarantee for 30 days from the date of purchase.</p>	 <p>Security & Privacy We respect customer privacy. We use McAfee's security service to provide you with utmost security for your personal information & peace of mind.</p>
---	---	--

Any charges made through this site will appear as Global Simulators Limited.

All trademarks are the property of their respective owners.